

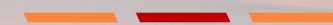

KAIYI X3

PRODUCT MANUAL





BACKGROUND





Kaiyi Automobile products cover SUV, new energy and other models, traditional fuel and new energy products.

Kaiyi Automobile takes customer demand as the center, integrates global superior resources, meets the needs of young people around the world for high-quality life through the appearance and interior with a very fashionable and sporty sense, the mainstream humanized intelligent interconnection configuration, the industry mature product technology and performance application.

Kaiyi is part of Chery Automobile Group

Chery Automobile Group is a diversified enterprise group with the automotive industry chain as the core. It has five brands (Land Rover Jaguar, EXEED, KAIYI Automobile, JETOUR, and Chery Automobile), among which KAIYI is one of the five brands.

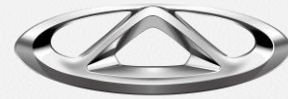

奇瑞汽车



01



02



03



04



05



Complementary advantages

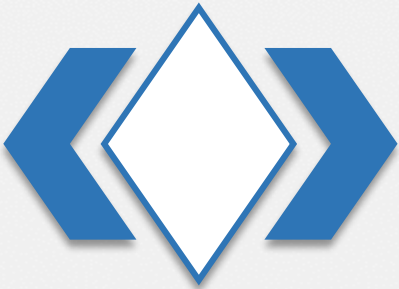

Abundant state owned capital



Full series production qualification



Cost advantage of factors of production



Decades of car building heritage



Leading technology advantage



Mature platform advantages



KAIYI automobile Brand events

2014



In August, Chengdu auto show released the first intelligent connected SUV concept car i-cx



In August, he participated in the public welfare activity of "Million Nutrition Plan"



In April, Kaiyi c3r was launched in Chengdu auto show

2015



Kaiyi V3 was launched in August



In December, Kaiyi Crowdsourcing won the "Interactive Marketing Case" Award

2016

KAIYI automobile Brand events

2017



In January, it won the award of "Lucky China 2016 Loving Enterprise"



In June, the Kaiyi Crowdsourcing car entered the Beijing Museum



Kaiyi X5 launched in September



Kaiyi E3 launched in November

2019

2018



In December, the smart factory was completed and the new car was rolled off the production line

KAIYI automobile Brand events

2020



In January, Kaiyi Automobile obtained dual qualifications for passenger cars



Kaiyi X3 was launched in June



Kaiyi E5 EV was launched in September



In January, Kaiyi won the "2020 Responsible Brand" Award of China Philanthropy Festival



In March, the new car of Kaiyi X3 Pro was rolled off the production line

2021

Future • Wonderful

Excellent production guarantee

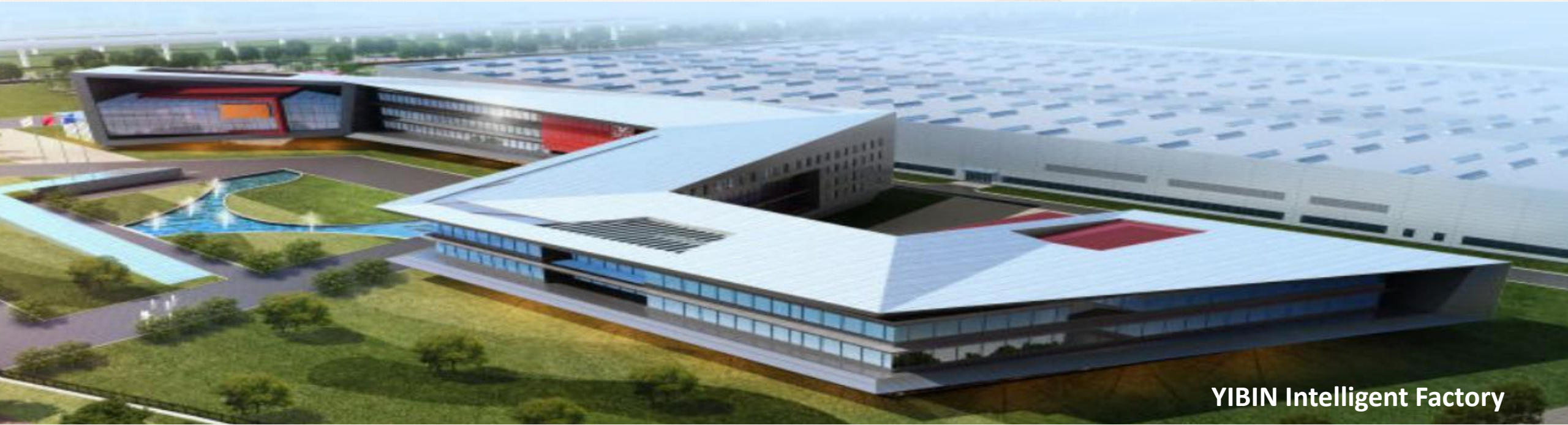

YIBIN Intelligent Factory

Kaiyi Intelligent Yibin new creation

The first phase of Yibin Kaiyi Automobile Intelligent Factory, built according to international advanced standards, covers an area of **973 mu**, with a total investment of **3.7 billion yuan** and a planned capacity of **150,000 vehicles**.

On December 24, 2019, the four process workshops of stamping, welding, painting and final assembly were completed and put into operation, opening a new chapter of Kaiyi Auto's steady development.

In 2020, the brand new products will be on the market, and the estimated output value will be **10 billion yuan**, the tax revenue will be **1.2 billion yuan**, and **2,000 people** will be employed.

Excellent Quality Assurance

Through the bench test, enhanced road test, three high test (high temperature climate, plateau environment, high cold climate), comprehensive performance test, user simulation road test, a total of more than 1 million kilometers of tests.



18 modules of performance test, covering more than 40 kinds of special road verification, 1 million kilometers of endurance test, covering all users' daily driving conditions, whether it is rugged and potholes on mountain roads or wide and flat city roads, you can do whatever you want.



High Temperature Plateau Extreme Environment



When the highest temperature reaches **45°C** and the highest altitude is **5100m**, the vehicle's performance of **power performance, drivability, air conditioning performance and user perception under the high temperature plateau environment**, as well as the complex road conditions on the plateau road, is fully verified to fully verify the durability and reliability of the vehicle.



Extremely Cold Limit Environment Test

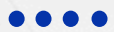

The minimum temperature is about **-40°C**, verifying the vehicle's **drivability, low temperature resistance of parts, air conditioning performance and user perception** in the high cold environment, so that the vehicle can achieve good cold start, hot start, stable idle speed and good drivability in the low temperature environment.

High Quality Accessories Supplier

CATL
宁德时代

Valeo
法雷奥

 BOSCH

ACTECO

ASUS®
华硕品质·坚若磐石

 科大讯飞
iFLYTEK

WLY 万里扬

HASCO
AUTOMOTIVE

Neusoft 东软



TSINGSHAN





CONTENTS

KAIYI AUTO

1

OVERVIEW

2

DESIGN

3

SAFETY

4

COMFORT

Part **1**

OVERVIEW





Product positioning

Smart multi-screen SUV

Fashion

S a f e

Comfort

Quality



- Floating roof
- Tailgate light bar
- Wingspan front grille
- Two-tone interior
- LED CHMSL

- Bosch ESP
- Speed alert system
- Driver mode selector
- Anti-theft alarm system
- AUTOHOLD system and TPMS system

- Luxury soft-touch instrument panels
- Flexible storage space
- 60:40 seat split
- 2632mm super long wheelbase

- CN95 high-efficiency anti-bacterial cabin filter
- Rear AC vents + single USB jack
- 10.25 inch central control LCD screen

Part **2** **DESIGN**





Design Originated from Italy's fashion design



Founded in 1930, Pininfarina Automobile Design Co. Known as the soul of Italian design



Chief designer

Manuel Ferreira

Mainly worked for the following companies and developed concept and production

projects: FIAT, Volkswagen, Volvo, Hyundai, Peugeot, PSA, Jaguar, etc.

FACEL VEGA(HK) (exterior design)
FIAT Uno 2016(exterior design)
FIAT Argo 2017(exterior design)
PEUGEOT Escapade(exterior design)



Basic parameters

Length * width * height: 4400*1831*1653mm

Curb weight (KG) :1336MT/1366CVT

Wheelbase: 2632mm

Maximum power: 85Kw/6150rpm

Maximum torque: 143N.m/4000rpm

Minimum ground clearance: 158mm





Wingspan Front Grille



Wingspan front intake grille

Express youthful ideals,
strong, athletic and
without blemish.



Sports front bumper + Sculpture surface



- Silver guard and sports front bumper make the whole vehicle more sporty;
- Integrated energy absorption two-stage buffer design, more effective pedestrian protection;
- The area under the headlamp is strong and powerful with sculpture surface;





Transmission-type LED Headlamp

Lens type LED light source, good concentrating effect, long irradiation range; Effectively increase the safety of driving at night.



Three advantages of transmission-type LED light source:

- Good concentrating effect and long irradiation range (the irradiation distance can reach more than 150m);
- Low power consumption, less than 0.1W;
- Long service life, up to 100000 hours.



Subsection Waist line

1、 The double waistline design of the side wall makes it more rhythmic and dynamic.

2、 Rising water cut design, increase the body posture subduction sense, more dynamic movement.





Subsection Waist line



The waist line design of Kaiyi X3 is similar to Land Rover and Bentley Timoon , so that the vehicle has more sense of hierarchy and grade.





18 "Sport aluminum alloy wheels



- 5 pieces of diffusion blade modeling, using fine polishing technology, with a strong sense of movement;
- The knife-edge hub can effectively cut off the airflow at high speed, increase the downforce and enhance the driving stability
- Greater ground grip and smaller flatness to improve vehicle handling.



LED pulling-through tail light

The taillight adopts three-dimensional sculpting design with distinct lines; The contour of the LED lamp belt is prominent, full of stereoscopic feeling; The through-running running lights show a W shape as a whole



KAIYI X3



Porsche

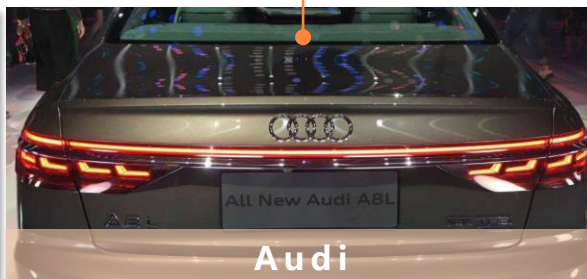

Audi



Lincoln



LED High Position Stop Lamp



- Wide modeling, higher brightness, lighting speed, can effectively warn and prevent car rear-end and other accidents;
- Pollution-free, long life (theoretical life of more than 50,000 hours), more energy saving and environmental protection.



Warped-tail design

- The rear bumper shape is angular, with a higher sense of power;
- Lower part of the silver decorative board slightly warp up, the visual elevation of the tail, promote the sense of movement.





Multiple color combinations

These colors represent youth which are often full of hope for the future, they have young blood, the vitality, and "not afraid of the tiger title" the spirit, which are an entrepreneur should possess the following qualities



White and
Black



Red and
Black



Gray and
Black

Part **3**

SAFETY





Bosch ESP body stability system

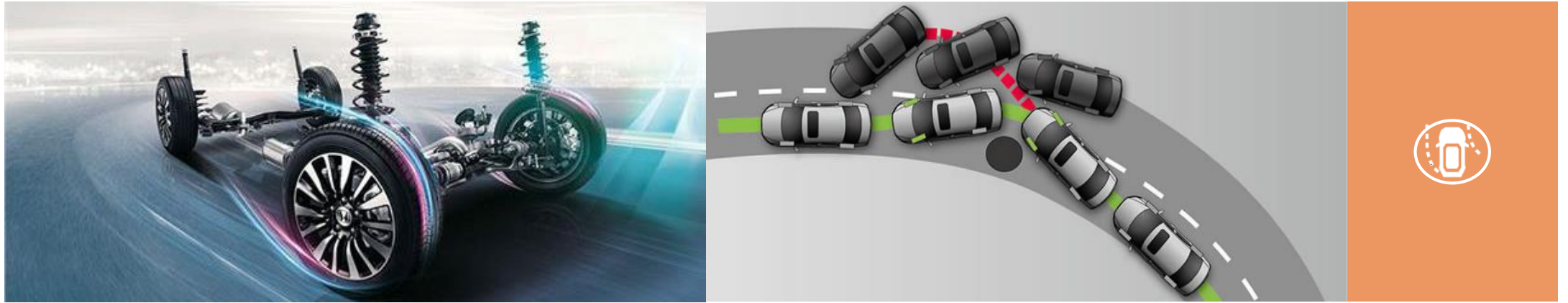

- The adjustment accuracy of Bosch ESP 9.3 on KaiyiX3 is 33 times higher than that of Bosch ESP 9.1 on most models in the market;
- The dynamic control of the vehicle body is more delicate, which can effectively improve the acceleration stability and steering stability;
- It can effectively reduce vehicle skidding, improve the acceleration performance of vehicles on low attached roads such as ice and snow roads, and increase driving safety.



Integrated cage body



- The longitudinal and transverse parts of the car body are connected in a series of rings, just like Taiji;
- When the collision occurs, the impact force is absorbed by the cage body structure, and the passenger compartment will not be damaged, so as to ensure the safety of the people in the car.





EPS Electric power steering system



- The whole system is equipped with EPS as standard to improve the stability and comfort of vehicle handling; It realizes low inertia, low friction and high efficiency, improves driving comfort and achieves high output.
- The steering effect is light at low speed and steady at high speed;
- Compared with hydraulic power, the fuel economy is better.





TPMS tire pressure monitoring



- Direct tire pressure monitoring, drivers and passengers can timely understand the tire condition through the data feedback of LCD instrument or central control large screen;
- The data includes the tire pressure and temperature of each tire, so that the driver can take timely measures to ensure the safety of drivers and passengers in case of abnormal tire.



4 Reverse Parking Sensors

- The rear of Kaiyi X3 is equipped with 4-Probe reversing radar, which makes reversing more comfortable.
- The maximum monitoring distance is 1.5m;
- Ultra high sensitivity, timely voice reminder;
- Progressive sound effect, changing volume and frequency with distance.



Part **4**

COMFORT





Double 10.25 inch large screen dashboard



- Large size and high resolution
- Full sense of science and technology, strong visual impact; More convenient information reading



10.25 inch high resolution HD central control screen

Imax8 + 4G hardware platform:

1920*720 resolution, support 1080P HD video playback, experience IMAX level HD screen effect.

High brightness:

The brightness level of 1000cd / m² is the same as that of Mercedes Benz, which makes reading information clearer in the daytime.

High contrast:

Close to the high contrast of consumer electronics (1000:1), the image is clear and bright.

Multi-touch:

Android 9.0 System, to reach the level of mobile phone contact, to achieve more touch action.





7-inch full LCD instrumentation

1280 * 480 resolution, high image definition, good display effect.

Abundant Vehicle information display:

It can display the clock, tire pressure display, instantaneous fuel consumption, mileage subtotal, driving range, gear information and other vehicle information.



Visual digital display: the information reading is more intuitive and convenient.



Dynamic track HD visual reverse image

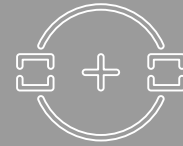

- High definition camera, sensitive response, clear and smooth display effect;
- Display the reversing track in real time and plan the reversing route intelligently;
- Distance display and reminder function to ensure the safety of reversing.



I-Cockpit



- Kaiyi X3 adopts the enveloping cabin layout to ensure the convenience of the operation of the drivers and passengers inside the vehicle.
- The overall interior with a large area of black to set the tone, increase the sense of fashion; The addition of leather wrap, chrome trim and stitching also enhances the texture.



Large space

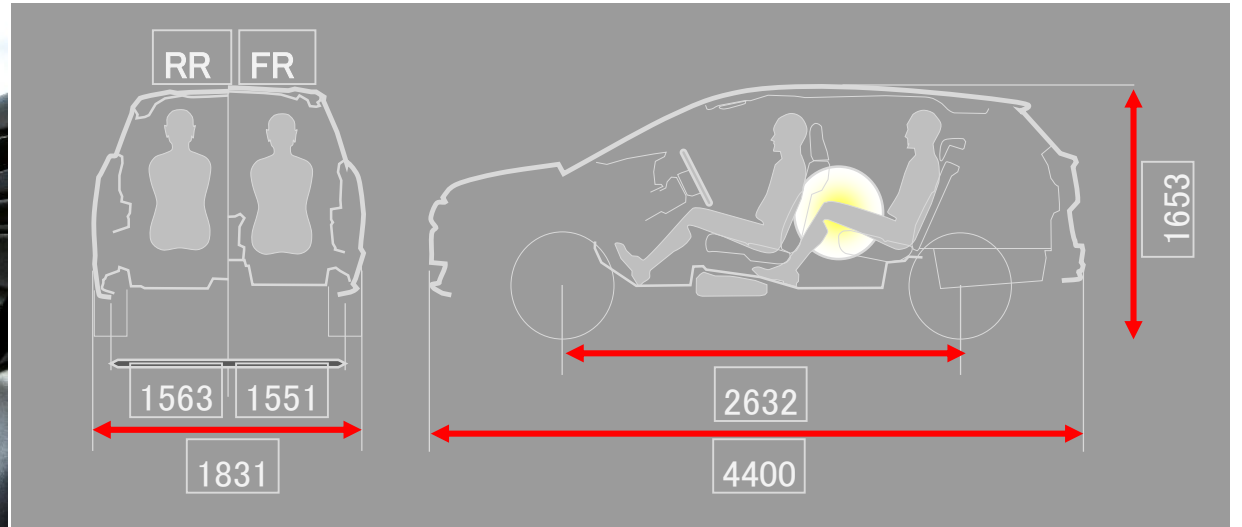

- The same class long wheelbase, up to 2632mm;
- Wide and comfortable front and rear space.



Flexible interior space



Trunk cover curtain increases privacy;



the back seat can be folded with one key;



6:4 The split body is put down, and the space is effectively extended





Keyless entry and Start/ stop buttons



Keyless entry

- High sensitivity, effective range 1.2m;
- Close to the vehicle, the door automatically unlocks without pressing the key,
- After getting off the car, it will automatically lock away from the vehicle for a certain distance.



Start/ stop buttons

- Just click to start the vehicle;
- Save the steps to find the key, more convenient and fast.



Electric adjustment outside rearview mirror

- Open and close the rearview mirror with one button, which makes the narrow space more convenient and safer;
- Integrated exterior rearview mirror turn signal to remind vehicles and pedestrians in time.

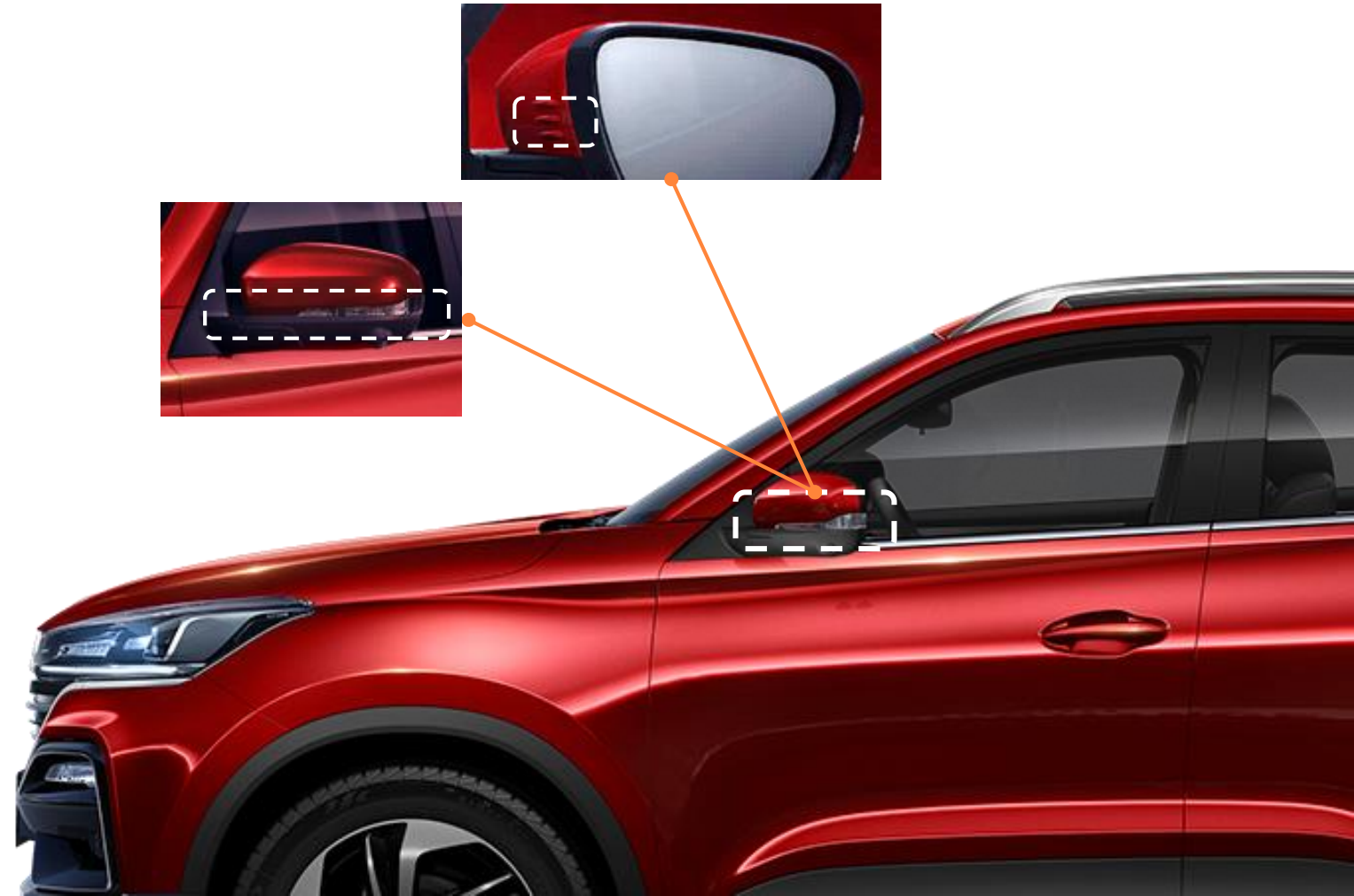



High texture soft touch instrument panel

- The instrument panel is made of high-quality plastic lining material with delicate texture;
- The treatment mode of female mold adsorption process and real suture makes the whole center console feel like a luxury car.





Match steering wheel of a luxury vehicle

- Simple and fashionable, more recognizable;
- The thickness is suitable, and the leather package has excellent grip;
- The multi-function button has rich functions, reasonable distribution and convenient use.





Air outlet of rear air conditioner + Dual USB socket



- Front and back row share the cool and warm, super luxury enjoyment;



- The whole system is equipped with intelligent control electric air conditioner as standard;



- Front dual USB ports + rear dual USB ports;



- Support fast charging of mobile phone



Cruise control function



- Simple operation and timely response;
- Keep the vehicle running at a constant speed (start when the speed is higher than 40km/h).



AUTOHOLD+Electronic handbrake

- The appearance of EPB electronic handbrake, especially the appearance of auto hold, saves the vehicle central control space and greatly improves the practicability;
- It can reduce the burden of right foot and right hand in traffic jam, and put an end to the inconvenience caused by insufficient strength to pull the handbrake (especially some Petite Ladies);
- The most important point is that the traditional handbrake can only lock the rear wheels. Now, if you need emergency braking in the process of driving, pull up the handbrake button for more than one second, and the electronic handbrake will choose the appropriate braking force according to the speed to ensure the driving safety, so as to further improve the active safety performance.





Multi road driving mode

Two driving modes, sports and energy saving, can be switched at any time.

Normal mode:

Stable output, meet the needs of daily driving, improve fuel economy.

Sport mode:

Mode instant acceleration, throttle response faster, improve driving pleasure





Shift reminder



According to the current working condition, the trip computer displays the arrow and target gear to remind the user to shift gears reasonably.

- When the "up" arrow is displayed on the indicator light of the instrument, the upshift operation will be prompted;
- When the arrow direction is "down", it prompts to downshift.

THANK YOU

